

SP SERIES HIGH CAPACITY HOSE REELS



COXREELS® SP Series “Single Product Delivery” spring driven hose reels are built to handle large hose diameters. Used in applications demanding large volume delivery in low and medium pressures such as fuel and water. The sturdy box-style frame has heavy duty steel cross supports to all four corners for extra strength and rigidity.

LOW PRESSURE

Dual braid hose for applications 17 to 21 BAR and temperatures to 65° C. Reel less hose 120° C. For higher temperatures and pressures, see price sheet or consult factory. **NOTE: Do not exceed listed hose O.D. to obtain maximum length.**

HOSE							LESS HOSE		SIZE INDEX
MODEL	I.D. mm	O.D. mm	LENGTH m	BAR	INLET/OUTLET N.P.T. mm	Kg.	MODEL	Kg.	
SLP-4100	13	19	30	21	13	50	SLPL-4100	44	1
SLP-550	19	17	15	21	19	45	SLPL-550	39	2
SLP-575	19	17	23	21	19	62	SLPL-575	53	3
SLP-5100	19	17	30	21	19	68	SLPL-5100	57	3
SLP-625	25	38	8	21	25	48	SLPL-625	41	4
SLP-650	25	38	15	21	25	63	SLPL-650	49	5
SLP-675	25	38	23	21	25	88	SLPL-675	67	6
Please consult factory for reels with hose	32	46	8	17	38**	-	SLPL-725	50	7
	32	46	15	17	38**	-	SLPL-750	56	8
	38	52	8	17	38	-	SLPL-825	49	7
	38	52	11	17	38	-	SLPL-835	58	8
	38	52	15	17	38	-	SLPL-850	63	9

** Reducer #1578 is required for 32 mm hose. Not supplied with reel, see page 52

MEDIUM PRESSURE

Steel reinforced 100 RI hose for applications 103 to 172 BAR and temperatures to 120° C. For higher temperatures and pressures, see price sheet or consult factory. **NOTE: Do not exceed listed hose O.D. to obtain maximum length.**

HOSE							LESS HOSE		SIZE INDEX
MODEL	I.D. mm	O.D. mm	LENGTH m	BAR	INLET/OUTLET N.P.T. mm	Kg.	MODEL	Kg.	
SMP-4100	13	21	30	172	13	63	SMPL-4100	51	1
SMP-550	19	27	15	103	19	49	SMPL-550	40	5
SMP-575	19	27	23	103	19	68	SMPL-575	55	6
SMP-5100	19	27	30	103	19	75	SMPL-5100	57	6
Please consult factory for reels with hose	25	35	8	138	25	-	SMPL-625	42	5
	25	35	15	138	25	-	SMPL-650	50	6
	25	35	23	138	25	-	SMPL-675	61	9

REEL DIMENSIONS

Technical Data Sheets Available On Website

SIZE INDEX	W mm	H mm	L mm	X mm	Y mm	Ø mm	Dw mm
1	470	521	581	391	546	267	191
2	498	521	581	391	546	267	191
3	498	622	670	391	635	267	191
4	498	521	581	391	546	267	191
5	498	622	670	391	635	267	191
6	533	724	772	391	737	267	191
7	445	622	670	391	635	267	191
8	457	724	772	391	737	267	191
9	508	724	772	441	737	267	241

Overall Dimensions

Base

Drum

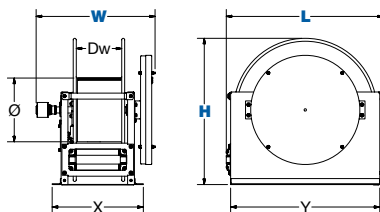

SP SERIES :: REEL SPECIFICATIONS

SWIVEL

- External fluid paths with machined from solid brass 90° full-flow NPT swivel inlets
- Swivel Seals: NITRILE (AFSL on 25 mm models)
- Electroless nickel plated steel swivel on 25 mm models
- Straight in-line aluminum swivel on 38 mm models

DESIGN & STRUCTURE

- Reel features a sturdy box-style frame design
- Reel adjusts to wall, floor, vehicle & overhead positions
- Heavy gauge 6 mm steel base for maximum strength
- Reinforced steel frame provides maximum strength & stability
- Long lasting self-lubricated flange bearings for smooth rotation
- Heavy duty 25 mm stainless steel pinch-proof rollers

RETRACTION

- Enclosed factory tuned & matched cartridge-style spring motor
- Non corrosive stainless steel pawl spring
- Cast iron lock ring with non-sparking bronze pawl
- Multi-position lock ratchet mechanism secures hose at desired length

SIGNATURE FEATURES

- Professional grade heavy duty steel construction
- Durable proprietary CPC™ powder coat process
- Rolled edges & ribbed discs provide strength & safety
- Leading 2-year manufacturer's limited warranty
- Made in the U.S.A. - Sold & Supported Worldwide

POSSIBLE FIELDS OF APPLICATION

- General Industrial
- Bulk Handling
- Washdown
- Lubrication
- Fuel Delivery
- Chemical Fluid Transfer
- Lube Skids & Trucks
- Service / Mechanic / Utility Vehicles
- Mining, Construction & Railroad Operations
- Aircraft & Fleet Maintenance
- Marine, Offshore & Ship Building

ACCESSORIZE YOUR REEL :: PG 50

- O-Rings & Swivels
- Assorted Reel Accessories



SPRING DRIVEN